

**Passive Antenna
Model: GLP1-P1P**

Antenna:	
Center Frequency	1580 ± 3 MHz
VSWR	2.0 max.
Bandwidth	15 MHz min.
Impedance	50 Ω
Peak Gain	4 dBic min.
Ground Plane	70 mm x 70mm
Gain Coverage	≥ -4dBic at -90° ≤ θ ≤ 90° (over 75% volume)
Power Handling	1 watt
Polarization	RHCP
Mechanical:	
Weight	≤10 gram
Size	25 x 25 x 2mm
Environmental:	
Working Temperature	-40°C < T < +85°C
Storage Temperature	-40°C < T < +85°C
Vibration	Sine Sweep, 1G(0-P), 10-150-10Hz each axis
Humidity	95%~100% RH

* Specifications subject to change without notice.

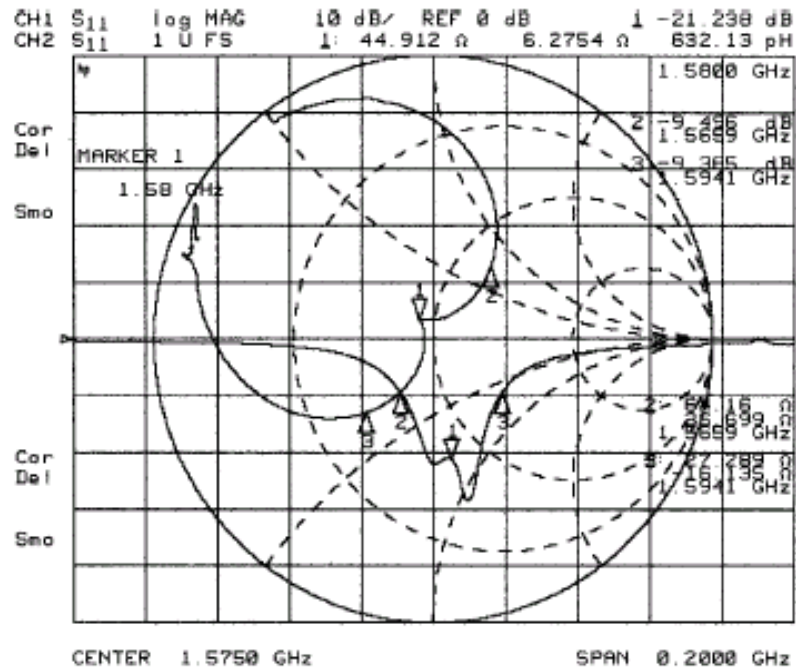

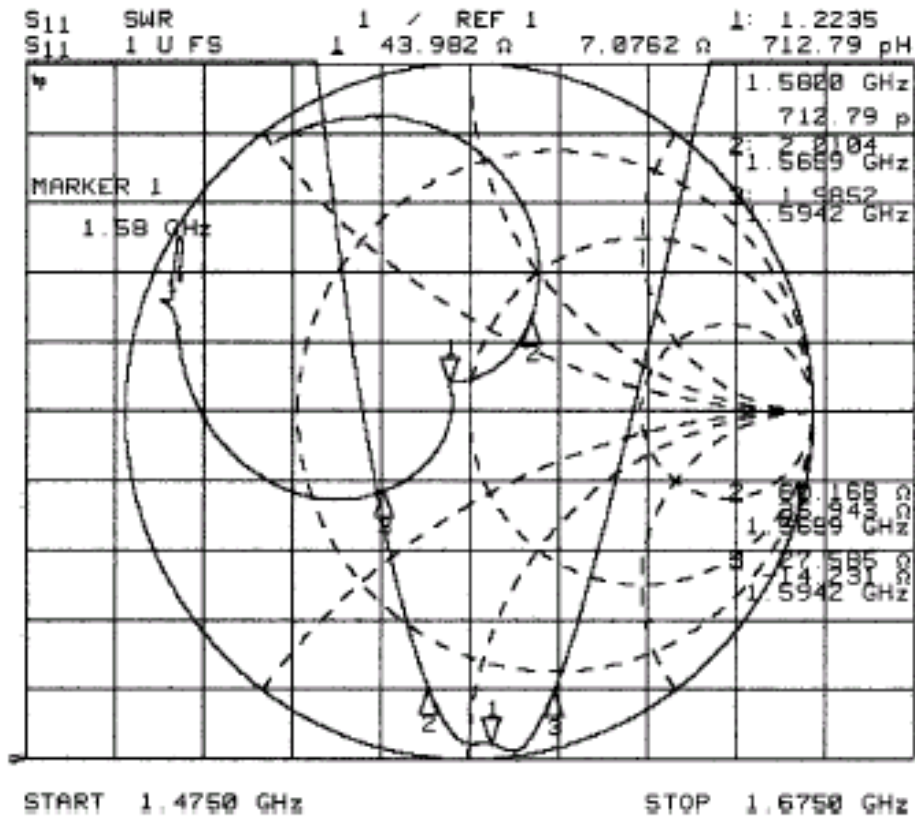

near-field amplitude

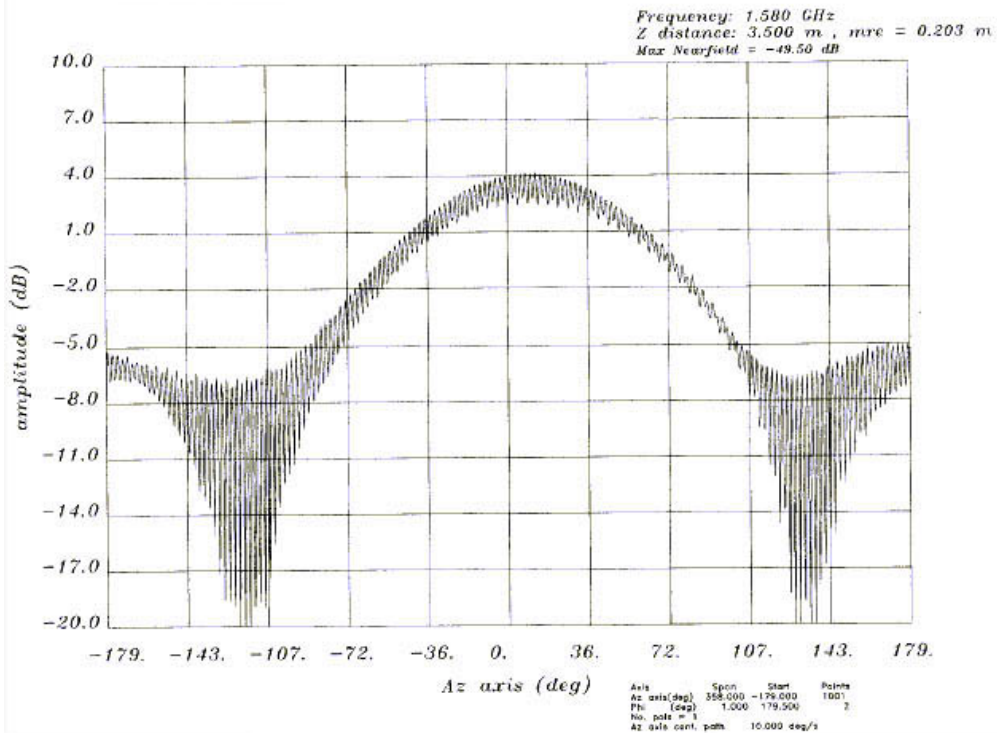

Polar plot

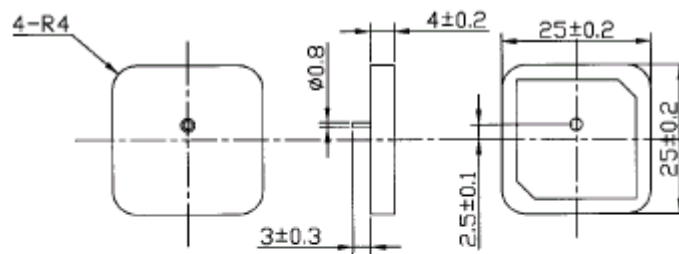
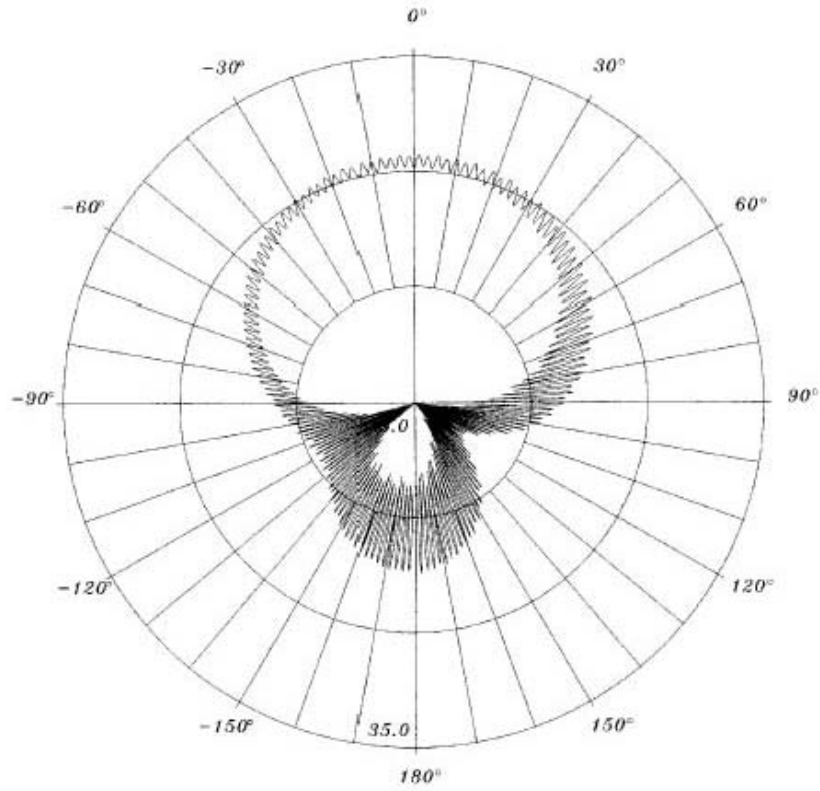

Material: Ceramic
Unit: mm